

# WB 536 SKALVBBC

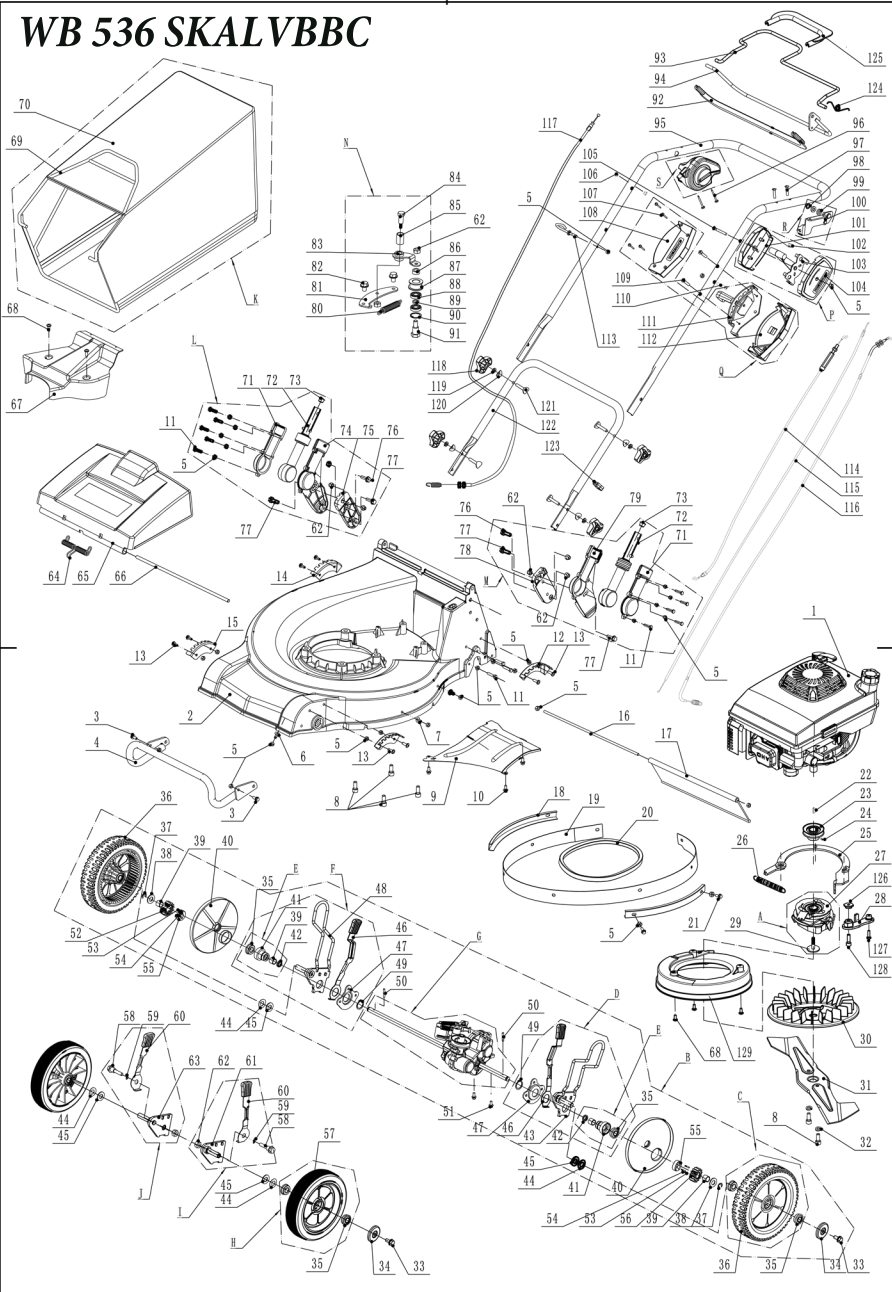

No.	ID Zboží	Název
1		engine
2	5340101010B/42	chassis
3	0102006020	bolt
4	5340118010/22	bumper
5	0202006000	lock nut
6	0109006016	screw
7	0109006014	screw
8	0103010025	screw
9	5340102010/42	bottom deflector
10	4820104010	lock screw
11	0101006025	bolt
12	5340105010/01	left-rear graduator
13	0104006016	screw
14	5340106010/01	right-rear graduator
15	5340108010/01	front graduator
16	5340116010/02	rear pivot
17	5320125010	rear deflector
18	5340109010/22	outer reinforcer
19	5340110010/22	inner reinforcer
20	5620133021	V-belt
21	0102006010	bolt
22	4510401010	key
23	4820401020	pullet
24	0105006006	locating screw
25	5380515010B/22	cable bracket
26	5380515020B	spring
A		BBC component
27	BBC01	blade clutch
28	5380515030B	rod
29	BBC02	central bolt
30	5380515040B	fan
31	5380401010B/22	blade
32	0401010000	spring washer
33	0102008016	bolt
34	48R0210012/01	hub cap
35	5310213010	bearing
36	5340309012	rear wheel
37	1301009000	check ring
38	5020311010/04	washer
39	5320326010	bearing
40	5340310010	anti-dust cover
E	Y065340	bearing sheath assembly
41	5340308010/02	bearing sheath
42	5320327010	anti-dust ring
43	5340301010/01	left-rear connector welding
44	5310211010/04	sping washer
No.	ID Zboží	Název
88	609-2RS	bearing
89	5340130010/02	spacer2
90	0901024000	check ring
91	5340131010	bolt

No.	ID Zboží	Název
45	5310210010/02	washer
46	5340303010	rear adjustment lever
47	5340305010	shaft bracket
48	5340302010/01	right-rear connector welding
49	1002024000	check ring
G	Y20534P0	commercial axle assembly
50	HQ000100060	slide pin
51	0101006018A	screw
52	HQ000100020	pinion
53	HQ000100030	active pin
54	HQ000100040	sping
55	HQ000100050	holding base
56	HQ000100010	pinion
57	5340206012	front wheel
58	5340205010	bolt
59	5340507010	spring washer
60	5340203010	front adjustment lever
61	5340201010/01	left-front connector weldment
62	0202008000	lock nut
63	5340202010/01	right-front connector weldment
64	4820128010	twist spring
65	5340113010	rear cover
66	5340115010/01	pivot of rear cover
67	5340103010	upper belt shield
68	4820122010	lock screw
G	5340601010G	grass catcher assembly
69	5340603010/22	frame
70	5340612010G/81	grass bag
71	5380109040	cover
72	5380111010	WBAVS
73	5380111020	plug
74	5380110030/22	right handle bracket
75	5380110020/22	right bracket adapter
76	0102008025	bolt
77	0102008020	bolt
78	5380109020/22	left bracket adapter
79	5380109030/22	left handle bracket
N	Y095341	tensional component
80	5340127010	sping
81	5340124010/02	plate
82	4820113010	lock bolt
83	5340125010/02	arm weldment
84	5340126010/02	central bolt
85	4820112010	nylon sheath
86	5340129010/02	spacer
87	5340128010	pulley

92	5380511010	lever sheath
93	BBC000000020/22	blade clutch lever
94	BBC030000000/22	wheel clutch lever
95	BBC000000010/22	upper handle
s	BBC010000000	blade clutch controller
96	0113050037	lock screw
97	0108006028	screw
R	BBC020000000	cable bracket component
98	4820307011	check cap
99	BBC020000010	nylon washer
100	BBC020100000	cable bracket weldment
101	4820520010	right cover
102	4820520020	plug
103	4820518020	bracket
104	4820519010	left cover
105	0108006050	screw
106	4820513010	plug
107	0106004025	screw
108	4820528010	upper cover
109	0108006030	screw
110	0108006035	screw
111	4820530010	bracket
112	4820529010	bottom cover
113	4510511010/01	start knob bracket
114	5340133010	self-propelled cable
115	4820539010	throttle cable
116	BBC040000000	wheel clutch cable
117	BBC050000000	blade clutch cable
118	4820541010	knob
119	0401008000	spring washer
120	4510510010/01	arc washer
121	5310510010/01	bolt
122	5380502010/22	lower handle
123	5320517010	cable clip
124	BBC000000021	
125	SW80036	lever sheath
126	BBC000000030/02	
127	4820106011	M6X20
128	0103008025	M8X25